

USER MANUAL – O De Vie WATER FILTER



1. COMPATIBLE FAUCETS

Compatible faucets will mostly have a filter screwed up to the faucet which can be detached. Once detached there is an inside thread. Inside the set you will find a few small metal adaptors which should fit most of the faucets. The 5 images below show compatible faucets which have such detachable filter.



Faucets below are NOT compatible. 'Showerhead' faucets or flat faucets are not adapted to connect the filter.



1) Assembling the diverter valve to the Tap

- Insert the metal outlet pipe into top cap of the filter unit.
- Screw the diverter valve onto the tap head (there are various connector pieces available in the set).
- Connect the rubber hose to the Diverter valve and screw it on with the screw which is available in the set.
- Insert the hose through the hole on the base stand of the filter.

2) How to insert your supply hose into the O de Vie Alkaline Ionizer.

- Take off the blue clip on the water entry at the bottom.
- Insert the hose into the hole.

Note: There are two insert depths for the hose attachment. If you have only pushed the hose into the first depth, the hose will easily pull out during use. **Push to insert the hose to the deepest second level** to secure the hose is fastened by the connector and will not pull out during use once it is inserted well.

3. after the hose is securely attached in the second position, then reattach the blue clip to keep the hose fastened.



3. USAGE GUIDE

O DE VIE Alkaline Ionizer:

Please read this before using your filter unit.

1. The Manual says to run water through the water filter for 30 minutes. This is based on 0.8L per minute flow rate, so if you run it at full flow you may reduce this to 10 minutes. The purpose is to saturate the media and to flush out any loose carbon.
2. Your O DE VIE Alkaline Ionizer is capable of running for up to 30 minutes without significant reduction in its ability to supply excellent pH and ORP results. After that time its performance will reduce, so try to limit the length of use to below 30 minutes and give O DE VIE Alkaline Ionizer at least 5-10 minutes 'rest' before re-use.
3. Flow rate is critical to performance as the energizing and alkalizing requires a set time for the water to pass through the activating media. To determine the correct flow rate (0.8 to 1 liter per minute) use a 1 liter container (2.11 US Pints) and time the output. Adjust your flow controller (see picture below) until the correct flow rate has been achieved. Normally all you need is approximately 1/2 a turn. Thereafter, use this flow rate for optimum results.
4. Because O DE VIE Alkaline Ionizer is always ionizing and creating energized water, your first 'shot' in the morning may have a slight metallic taste because the water has been in contact with the mineral layer for an extended time. To prevent this you can let the filter run for a few seconds before using the water.
5. The design of the O DE VIE Alkaline Ionizer means that after six months use it may begin to release some of the removed contaminants back into your water stream as the filters become saturated of the various unwanted substances it filters from your tap water. For this reason we recommend a strict maximum 6 month filter changeover. The cartridge has a capacity of 5000 Liter. If you use the filter excessively, then you might need to replace the cartridge faster. On average you can use about 25 liter per day.

Note: The Ceramic membrane in your filter will gradually become dirty as you use it. This will reduce flow. If you see your O DE VIE Alkaline Ionizer delivering less flow, open the top, turn on the tap to free the filter, and scrub the bottom ceramic area of the filter unit. .



ADJUSTING THE FLOW CONTROL USING A SCREW DRIVER'S EDGE

6. After installation, turn on the tap and let water run through the system for at least 30 minutes. The filtered water will be murky or slightly grayish/blackish due to carbon dust being washed off from carbon filters. Once water runs clear, the filtered water can be used directly for drinking, washing or cooking.
7. When you turn off the tap, filtered water may still flow out for another 20-30 seconds. This is NORMAL due to the residual pressure that has built up within the system while it was in use.
8. If the system is left unused for a few days in a row, the initial flow of the filtered water will be slightly grayish, as it has been soaking in the media for a long period. Just let water run for about 1-3 minutes until it is clear and system is ready for regular use again.

5. HOW TO CHANGE THE FILTER AND CLEAN THE CERAMIC FILTER LAYER

1) Taking off the Ceramic Filter for Periodic Cleaning

When the outflow of the filtered water decreases or stops completely, this indicates that the Ceramic Filter of the Cartridge is fully-covered with mud or sediment, making it difficult for in-coming water to pass through the system. The Ceramic Filter will need to be cleaned.

Note: Use the soft scouring pad provided. Do NOT use a hard toothbrush or metal scourers as these can damage the Ceramic Filter.

Important : Clean the Ceramic Filter of the Filter Cartridge with running tap water. **DO NOT** soak in any detergents or wash with any detergent-based cleaners.

1. Turn off the system.
2. Pull out the Outlet Pipe from the Top Cap (Diagram A).
3. Turn Casing Cover anti-clockwise to loosen (Diagram B).
4. Pull off the Top Cap (Diagram C).
5. **Important: Turn on tap water and it will push filter cartridge up (Diagram D)**
6. Take it out and wash with the sourcing pad provided (Diagram E)
7. Let water fill to about 1/5 of the casing. Then turn off the tap water
8. Re-install the cartridge. Flatten the handle. (F)
9. Finally, re-attach the Top Cap. Then screw on the Casing Cover clockwise and reconnect the Outlet Pipe (F)

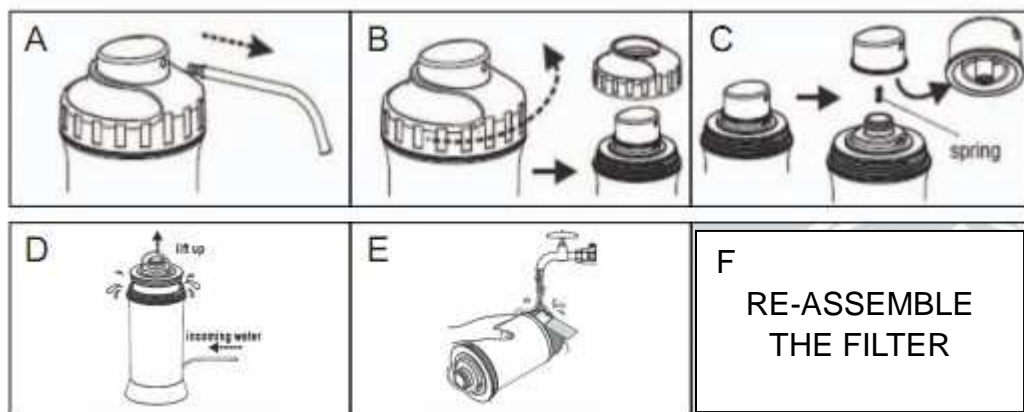

2) Replacing the Filter Cartridge

The Filter Cartridge will need to be replaced after about 5,000 liters of water or 6 months of usage. However, this depends on in-coming water quality and usage volume. When the ceramic filter breaks due to wear and tear or if filtered water has a taste of chlorine, it is time to replace the Filter Cartridge. To replace the filter Cartridge, refer to the same procedure for taking out the cartridge for periodic cleaning as on the image above.

6. NOTICES

1. Avoid to place the water filter close to a heat source. .
2. Avoid that the flexible tube is close to a fire or heat source to prevent that it melts or gets damaged.
3. Never run hot water through the unit, otherwise the will be damaged and the filter will leak.
4. Install the unit is a DIY. Please follow each step of the manual.
5. If the flow gets reduced then please wash the ceramic filter with the metallic sponge.
6. After the filter cartridge has been replaced, let the water run for at least 30 minutes before usage. For a new filter the same rule counts.
7. Close the diverter to the tap water when the filter is not used, otherwise, the water pressure remaining in the

casing will make the water rush out at the first seconds when you press down the open button.

8. Upon completion of the initial installation, turn on the faucet. Let the water run through the filter for 30 minutes, then it's ready for consumption.
10. It's better not to use detergents to clean the outside of the filter. .
11. If the installation and usage are not in accordance with the Manual and Notices, and there is damage, leaking or other defects linked to wrong usage or wrong installation then the consumers are responsible for this. We therefor ask you kindly to read the Manual carefully to secure long term benefit of your O DE Vie filter.

7. Frequently Asked Questions

Q1: Is it safe to drink water directly from O DE VIE water system without boiling?

A: YES, O DE VIE water system 8-Stage water purifier gives not only clean, but safe, health-giving water on demand. Boiling water before consumption has long been practiced to offer consumers assurance that the water is free from bacteria, but in actual fact, municipal treated water has been chlorinated or threaded in another way to ensure that bacteria is not present in our tap water. So boiling water is not necessary. Instead, what is required is a good filtration and purification and purification system, which will remove all the other contaminants present in our tap water that are hazardous to health such as chlorine, heavy metals, rust , lead and many others. However, there is absolutely no problem if you wish to boil the water to prepare hot beverages and for cooking.

Q2: Can I use the O DE VIE Water Purifier with untreated underground water?

A: Untreated underground water consists of an extremely wide spectrum of contaminants. Therefor we do not advise to use the O DE VIE filter for groundwater. O DE VIE Water Purifier is made for regular tap water. .

Q3: If the filtered water has a peculiar smell and tastes different, what should I do ?

A: The change in smell and taste could happen if the unit is kept with water contained inside for a few weeks. In this case, it is best to remove the cartridge and drain out the leftover water. All you need to do is rinse the inside casing and let the unit run for at least 15 minutes before resuming usage.

Q4. Can I run hot water through the O DE VIE Water System 8-Stage Water Purifier units?

A: No! Hot water will affect the efficacy and efficiency of the Ceramic Filter and the Carbon Filter in the unit, thus compromising on the quality of the filtered water.

Q5. Will boiling O DE VIE Water affect its health-giving properties?

A: No! When O DE VIE Water is heated the water keeps its health properties

Q6. Is O DE VIE water suitable for infants?

A: Certainly! Our human body fluids are naturally in small molecular clusters. . O DE VIE Water is perfectly safe and is the best kind of water that you can give them and yourself.

Q7: Can sick people benefit from O DE VIE Water?

A: Yes. In fact, cellular dehydration is the root cause of many illnesses and diseases. We refer to www.watercure.com which is based on more than 20 years of research by the famous Dr. Batmanghelidj. Doctors always advocate drinking lots of water whenever a patient is sick, in pain, or on medication. Water hydrates the cells and flushes out toxins. Those with illnesses should increase their consumption of O DE VIE Water to at least 10-15 glasses a day (2 -3 depending on your body weight).